

## ISE

- a1SE **Bridge, Display Matrix**  
*a1SE assd.*\* Bridge, Display Matrix, assembled
- b1SE **Bridge, BRIDGE AND HOLDER (AMERICAN DISPLAY MATRICES) ATTACHMENT** (see Plate 40)
- c1SE **Bridge, BRIDGE and HOLDER (TYPEFOUNDERS' MATRICES) ATTACHMENT** (see Plate 41)
- c1SE assd.*† Bridge, assembled, BRIDGE AND HOLDER (TYPEFOUNDERS' MATRICES) ATTACHMENT
- 1SE1 Locating Strip (see Plate 40)
- 1SE2 Locating Strip Screw (2),  $\frac{1}{4}'' \times \frac{9}{16}''$  (see Plate 40)
- 1SE3 Screw (3),  $\frac{1}{4}'' \times 1''$ , hexagon, to Mould
- 1SE8 Locating Strip Screw, Stop for Lever, BRIDGE AND HOLDER (AMERICAN DISPLAY MATRICES) ATTACHMENT (see Plate 40)
- 1SE9 Locating Screw, to Matrix Head, BRIDGE AND HOLDER (TYPEFOUNDERS' MATRICES) ATTACHMENT (see Plate 41)
- † Screw,  $\frac{3}{16}'' \times \frac{7}{16}''$ , to Matrix Head
- 1SE10 Spring Post for Matrix Seating Lever Spring, BRIDGE AND HOLDER (TYPEFOUNDERS' MATRICES) ATTACHMENT (see Plate 41)
- 1SE11§ Screw (3),  $\frac{3}{16}'' \times \frac{3}{8}''$ , to Matrix Head, BRIDGE AND HOLDER (TYPEFOUNDERS' MATRICES) ATTACHMENT (see Plate 41)
- Xa1SE **Bridge, Display Matrix, group**; consists of a1SE assd., 1SE3(3)
- Xb1SE **Bridge, BRIDGE AND HOLDER (AMERICAN DISPLAY MATRICES) ATTACHMENT, group**; consists of b1SE, 1SE1 and 2, 1SE8, Xb10SE, X38SE
- Xc1SE **Bridge, BRIDGE AND HOLDER (TYPEFOUNDERS' MATRICES) ATTACHMENT, group**; consists of c1SE assd., 1SE9, 1SE11(3)
- \*a1SE assd. consists of a1SE, 1SE1, 1SE2(2), Xa10SE, X11SE
- †c1SE assd. consists of c1SE, 1SE10, Xc10SE, Xa38SE, X41SE
- ‡Use 2 of the Screws 7SE3 supplied as part of the Super Caster equipment
- §Use also 3 Screws 7SE2 supplied as part of the Super Caster equipment

## 7SE

- 7SEE\* **Matrix Head, Display**
- a7SE1 Cover, side
- 7SE2 Cover Screw, long (3),  $\frac{3}{16}'' \times \frac{3}{4}''$
- 7SE3 Cover Screw, short (6),  $\frac{3}{16}'' \times \frac{7}{16}''$
- 7SE4 Cover, top
- 7SE5 Cover Screw, long (3),  $\frac{3}{16}'' \times 1''$
- 7SE6 Cover Screw, short,  $\frac{3}{16}'' \times \frac{13}{16}''$
- 7SE7 Oil Pipe, for Type Pusher Lever
- 7SE8 Pin (2), stop for Lifter Handle
- 7SE9† Screw,  $\frac{3}{8}'' \times 1 \frac{1}{16}''$ , hexagon, to Matrix Base Head

- † Screw,  $\frac{3}{8}'' \times 3 \frac{1}{16}''$ , though Matrix Head Base to Main Stand
- Xa7SE **Matrix Head, Display, group**; consists of 7SEE, a7SE1, 7SE2(3), 7SE3(6), 7SE4, 7SE5(3), 7SE6, 7SE9
- XX7SE **Matrix Head, Display, complete, type heights .918" and .9273", type heights .932" and over (specify type height) group**; consists of Xa7SE, Xa13SE, or Xb13SE or Xc13SE, X17SE, X19SE, 20SE, X21SE, X42SE, 43SE1
- \*7SEE consists of 7SE, 7SE7, 7SE8(2)
- †Use also 2 of the 3 Screws 6SE2 supplied with the Matrix Head, Composition. See group 6SE
- ‡Use the Screw 6SE3 supplied with the Matrix Head, Composition. See group 6SE

## IOSE

- a10SE **Matrix Holder (Display) Adjusting Pad, in Bridge**
- b10SE **Matrix Holder Adjusting Pad, in Bridge, BRIDGE AND HOLDER (AMERICAN DISPLAY MATRICES) ATTACHMENT** (see Plate 40)
- c10SE **Matrix Holder Adjusting Pad, in Bridge, BRIDGE AND HOLDER (TYPEFOUNDERS' MATRICES) ATTACHMENT** (see plate 41)
- 10SE1 **Adjusting Screw, BRIDGE AND HOLDER (AMERICAN DISPLAY MATRICES) ATTACHMENT** (see Plate 40)
- a10SE1 Adjusting Screw
- b10SE1 Adjusting Screw, BRIDGE AND HOLDER (TYPEFOUNDERS' MATRICES) ATTACHMENT (see Plate 41)
- 10SE2 Adjusting Screw Lock Plunger (see Plates 40, 41)
- 10SE3 Adjusting Screw Lock Plunger Spring (see Plates 40, 41)
- 10SE5 Guide Pin, BRIDGE AND HOLDER (AMERICAN DISPLAY MATRICES) ATTACHMENT (see Plate 40)
- Xa10SE **Matrix Holder (Display) Adjusting Pad, in Bridge, group**; consists of a10SE, a10SE1, 10SE2 and 3
- Xb10SE **Matrix Holder Adjusting Pad, in Bridge, BRIDGE AND HOLDER (AMERICAN DISPLAY MATRICES) ATTACHMENT, group**; consists of b10SE, 10SE1, 2 and 3, 10SE5
- Xc10SE **Matrix Holder Adjusting Pad, in Bridge, BRIDGE AND HOLDER (TYPEFOUNDERS' MATRICES) ATTACHMENT, group**; consists of c10SE, b10SE1, 10SE2 and 3

## IISE

- 11SEE\* **Matrix Holder (Display) Locating Key, in Bridge**
- 11SE1 Lever
- 11SE2 Lever Fulcrum Pin
- 11SE3 Lever Spring

- 11SE4 Pin
- X11SE **Matrix Holder (Display) Locating Key, in Bridge, group**; consists of 11SEE, 11SE1, 2 and 3
- \*11SEE consists of 11SE, 11SE4

## I3SE

- a13SEE\* **Matrix Lifter, Display, type height .918"**
- b13SEE† **Matrix Lifter, Display, type height .9273"**
- c13SEE‡ **Matrix Lifter, Display, type heights .932" and over (specify type height)**
- d13SEE§ **Matrix Lifter, BRIDGE AND HOLDER (TYPEFOUNDERS' MATRICES) ATTACHMENT** (see Plate 41)
- 13SE2 Block for Lifter Lever
- 13SE3 Block Spring
- 13SE4 Spring
- 13SE5¶ Stud (see Plate 41)
- 13SE6 Stud Rivet
- a13SE6 Stud Rivet, BRIDGE AND HOLDER (TYPEFOUNDERS' MATRICES) ATTACHMENT (see Plate 41)
- 13SE7 Stud Nut
- 13SE9 Stud Nut Lock Nut
- Xa13SE **Matrix Lifter, Display, type height .918", group**; consists of a13SEE, 13SE2, 3 and 4, 13SE7, 13SE9
- Xb13SE **Matrix Lifter, Display, type height .9273", group**; consists of b13SEE, 13SE2, 3 and 4, 13SE7, 13SE9
- Xc13SE **Matrix Lifter, Display, type heights .932" and over (specify type height), group**; consists of c13SEE, 13SE2, 3 and 4, 13SE7, 13SE9
- Xd13SE **Matrix Lifter, BRIDGE AND HOLDER (TYPEFOUNDERS' MATRICES) ATTACHMENT, group**; consists of d13SEE, 13SE2, 3 and 4, 13SE7, 13SE9
- \*a13SEE consists of a13SE, 13SE5 and 6
- †b13SEE consists of b13SE, 13SE5 and 6
- ‡c13SEE consists of c13SE, 13SE5 and 6
- §d13SEE consists of d13SE, 13SE5, a13SE6
- ¶Can be fitted only at Workshops

## I7SE

- a17SE **Matrix Lifter, Display**
- a17SE1† Shaft
- 17SE2E\*† Shaft Lever, assembled
- 17SE3 Shaft Lever Handle
- 17SE4 Shaft Lever Stop Pin
- 17SE5 Shaft Lever Taper Pin,  $\frac{11}{16}'' \times 1 \frac{1}{4}''$
- Xa17SE **Matrix Lifter Lever, Display, group**; consists of a17SE, a17SE1, 17SE2E, 17SE5
- \*17SE2E consists of 17SE2, 3 and 4
- †Can be fitted only at Workshops

## I9SE

- 19SE **Matrix Lifter Lever (Display) Shaft Lock Pin** (not supplied separately, order X19SE)
- 19SE1\* Knob
- 19SE2 Knob Taper Pin
- 19SE3 Spring
- X19SE **Matrix Lifter Lever (Display) Shaft**

Lock Pin group; consists of 19SE,  
19SE1, 2 and 3

\*Can be fitted only at Workshops

## 20SE

20SE Matrix Lifter (Display) Lock Wedge

## 21SE

21SE Matrix Lifter (Display) Lock Wedge  
Spring Box

21SE1 Cap  
21SE2\* Rod  
21SE3† Rod Collar  
21SE4 Rod Collar Taper Pin  
21SE5 Rod Yoke Lock Nut  
21SE6 Rod Yoke, Matrix Cam Lever  
21SE7 Spring  
21SE8 Yoke, Lock Wedge  
21SE9 Yoke Pin  
21SE10 Yoke Pin Split Pin,  $\frac{1}{16}'' \times \frac{1}{2}''$

X21SE Matrix Lifter (Display) Lock Wedge  
Spring Box group; consists of  
21SE, 21SE1, 21SE2E, 21SE5 to  
10 inclusive

\*21SE2E consists of 21SE2, 3 and 4

†Can be fitted only at Workshops

## 42SE

42SE1E\* Display Mould Guard  
42SE2 Hinge Pin  
42SE3 Hinge Pin Retaining Spring  
42SE4 Hinge Pin Retaining Spring Screw,  
 $\frac{3}{16}'' \times \frac{5}{16}''$ , to Matrix Head  
(Display) Cover, side  
42SE5E† Latch  
42SE6 Latch Hinge Pin  
42SE7 Latch Release Lever (not supplied  
separately, order 42SE5E)  
42SE8E‡ Latch Release Lever Fulcrum and  
Spring Post  
42SE9 Latch Release Lever Fulcrum and  
Spring Post Anchor Pin, for  
Spring  
42SE10 Latch Release Lever Fulcrum and  
Spring Post Nut  
42SE11 Latch Release Lever Stop Pin  
42SE12 Latch Spring  
42SE13 Window  
42SE14 Window Screw (4),  $\frac{1}{8}'' \times \frac{1}{4}''$   
42SE15 Window Screw Washer (4)

X42SE Display Mould Guard, group;  
consists of 42SE1E, 42SE2, 3 and  
4, 42SE5E, 42SE8E, 42SE12 and  
13, 42SE14(4), 42SE15(4)

\*42SE1E consists of 42SE1, 42SE11

†42SE5E consists of 42SE5, 6 and 7

‡42SE8E consists of 42SE8, 9 and 10

## 43SE

43SE1 Matrix Lifter (Display) Lock Wedge  
Spring Box Rod Yoke Pin, to  
Matrix Cam Lever

## 20SU

Display Mould Guard Attachment  
Object: To provide a Display  
Mould Guard for use with the  
Display Matrix Head  
For Super Casters numbered prior  
to 70630

20SU **Display Mould Guard Attachment;**  
consists of Xa3SA, a7SE1, X42SE  
Note: Super Casters numbered  
70630 and onwards incorporate  
this Attachment

### **34SU**

#### **Display Matrix Head and Equipment Attachment**

Object: To provide as  
Attachments, Display Matrix  
Head and Equipment  
Attachment for Super Casters  
previously ordered without  
them

For Super Caster (Skeleton) not  
equipped with Composition  
Matrix Head and Equipment  
Attachment or Counter  
Mechanism and Equipment  
Attachment

34SU1 **Display Matrix Head and Equipment Attachment;** consists of Xa3SA, Xa1SE, Xa5SE, 6SE2(2), 6SE3, XX7SE, Xa22SE, Xa23SE, Xa24SE, X25SE, X26SE, X27SE, X28SE, X30SE, X31SE, Xa34SE, X35SE, X36SE, 12SH1 to 4 inclusive, 12SH7, Xf13SH, b19SHH, Xa20SH, Xa6SL, Xa7SL, 11SL1, X12SL, X13SL, Xb15SL, X16SL, b17SL1(3), X19SL, X20SL, 22SL1

For Super Casters equipped with  
Composition Matrix Head and  
Equipment Attachment

34SU2 **Display Matrix Head and Equipment Attachment;** consists of Xa3SA, Xa1SE, XX7SE, X30SE, X31SE, 12SH2, 3 and 4, 12SH7, Xa20SH, Xa6SL, Xa7SL, X13SL, Xb15SL, X16SL, X20SL

For Super Casters equipped with  
Counter Mechanism and  
Equipment Attachment

34SU3 **Display Matrix Head and Equipment Attachment;** consists of Xa1SE, Xa5SE, 6SE2(2), 6SE3, XX7SE, Xa8SE, Xa22SE, Xa23SE, Xa24SE, X25SE, X26SE, X27SE, X28SE, X30SE, X31SE, Xa34SE, X35SE, X36SE, 12SH1 and 2, 12SH4, 12SH7, Xa6SL, Xa7SL, 11SL1, X12SL, X13SL, Xb15SL, X16SL, b17SL1(3), X19SL, X20SL

For Super Casters equipped with  
Composition Matrix Head and  
Equipment Attachment and  
Counter Mechanism and  
Equipment Attachment

34SU4 **Display Matrix Head and Equipment Attachment;** consists of Xa1SE, XX7SE, X30SE, X31SE, 12SH2, 12SH4, 12SH7, Xa6SL, Xa7SL, X13SL, Xb15SL, X16SL

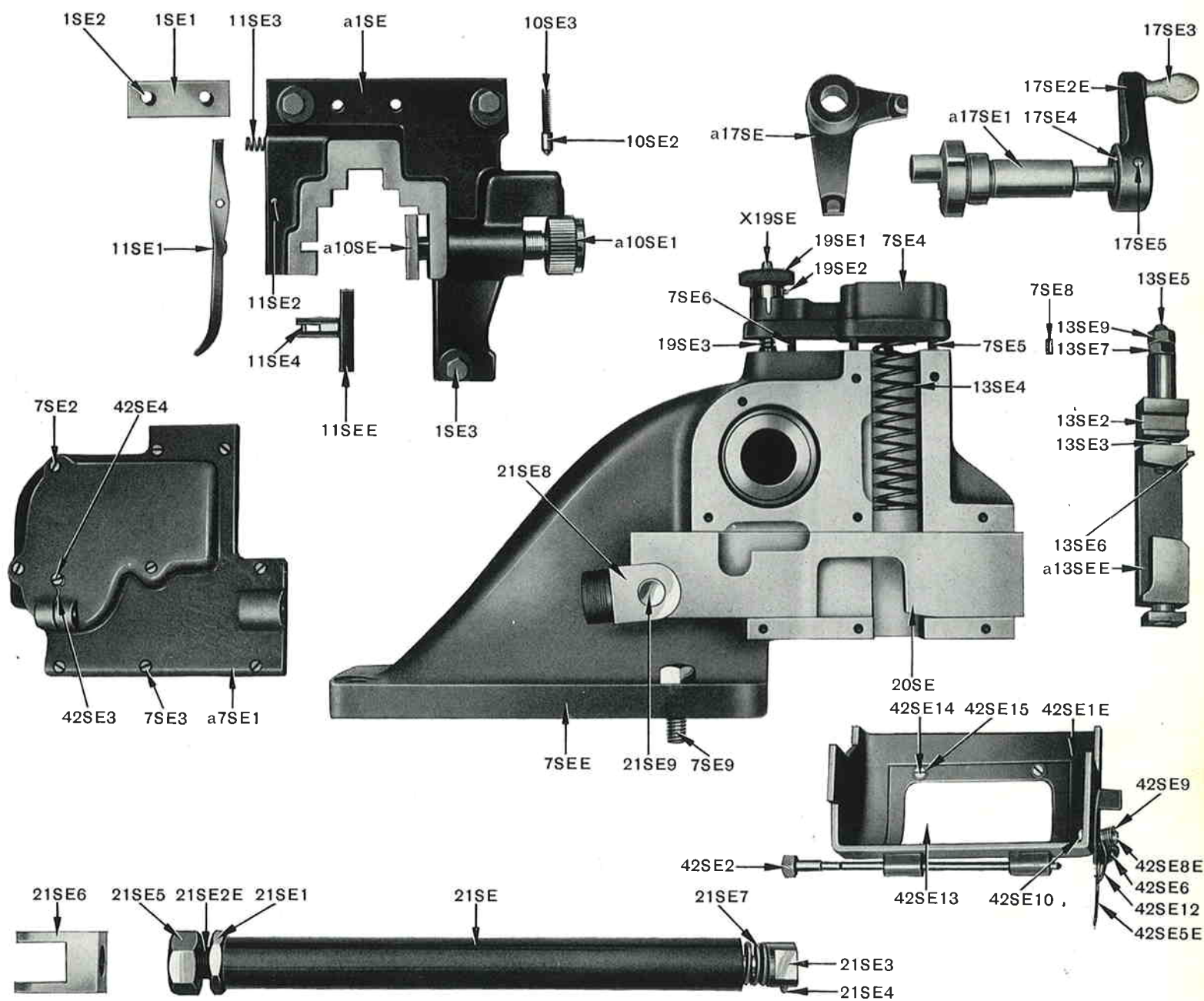

**4SD****Counter Bracket**

- 4SD6 Locating Key, front  
 4SD7 Locating Key Screw,  $\frac{1}{4}'' \times \frac{1}{2}''$

**6SD****Jet Block Driving Rod**

- a6SD3 Guide  
 a6SD4 Guide Screw (2),  $\frac{3}{16}'' \times \frac{7}{16}''$ , to Counter Bracket  
 6SD5 Spring  
 6SD6 Washer

**7SD****Jet Block Driving Rod Connection Rod**

- 7SD1 Lock Nut, left hand  
 7SD2 Lock Nut, right hand  
 a7SD3 Yoke, right hand, to Driving Rod  
 a7SD4 Yoke Pin  
 a7SD5 Yoke Pin, Split Pin,  $\frac{1}{16}'' \times \frac{1}{2}''$   
 7SD6 Yoke, left hand, to Type Carrier Cam Lever  
 a7SD7 Yoke Position Pin  
 7SD8 Yoke Position Pin Screw,  $\frac{3}{16}'' \times \frac{1}{4}''$   
*Xb7SD* Jet Block Driving Rod Connection Rod group; consists of 7SD, 7SD1 and 2, a7SD3 to 5 inclusive, 7SD6, a7SD7, 7SD8

**8SD**

- a8SD **Lead Clamp Intermediate Lever**  
 8SD1 Fulcrum Pin, to Counter Bracket  
*Xa8SD* Lead Clamp Intermediate Lever group; consists of a8SD, 8SD1

**9SD**

- b9SD **Lead Clamp Intermediate Lever Rod**  
 a9SD1 Nut Lock Nut  
 a9SD2 Nut  
 b9SD4 Swivel  
 9SD5 Swivel Collar, lower  
 a9SD6 Swivel Circlip  
 9SD7 Swivel Washer  
 b9SD8 Yoke, to Mould  
 9SD9 Yoke Lock Nut  
 9SD11 Sleeve  
 9SD12 Spring  
 9SD15D\* Swivel Collar, upper  
 9SD16 Swivel Collar Pin  
 9SD18 Clip, for Rod Yoke Pin  
 9SD19 Clip Collar  
*Xd9SD* Lead Clamp Intermediate Lever group; consists of b9SD, a9SD1

- and 2, b9SD4, 9SD5, a9SD6, 9SD7, b9SD8, 9SD9, 9SD11 and 12, 9SD15D, 9SD18 and 19, b17SD  
 \*9SD15D consists of 9SD15 and 16

**10SD**

- 10SD **Lead Clamp Intermediate Lever Spring Box**  
 10SD1 End  
 10SD2D\* Rod  
 10SD3† Rod Collar  
 10SD4 Rod Collar Taper Pin,  $\frac{3}{32}'' \times \frac{1}{2}''$   
 10SD5 Rod End, to Matrix Cam Lever  
 10SD6 Rod End Lock Nut  
 10SD7 Spring  
 10SD8 Yoke, to Intermediate Lever  
*X10SD* Lead Clamp Intermediate Lever Spring Box group; consists of 10SD, 10SD1, 10SD2D, 10SD5 to 8 inclusive  
 \*10SD2D consists of 10SD2, 3 and 4  
 †Can be fitted only at Workshops

**11SD**

- 11SD **Matrix Lifter**, standard, Borders and Dashes (for type heights .918" to .9815")  
*a11SD* Matrix Lifter, special, Borders and Dashes (for type heights .960" to 1.017")

**12SD**

- a12SD **Matrix Lifter Bracket**  
 a12SD1 Screw,  $\frac{1}{2}'' \times 3''$ , hexagon, to Counter Bracket  
 12SD2 Cover  
 12SD3 Cover Screw (6),  $\frac{3}{16}'' \times \frac{3}{8}''$   
*Xa12SD* Matrix Lifter Bracket group; consists of a12SD, a12SD1, 12SD2, 12SD3(6)

**13SD**

- 13SD **Matrix Lifter Lock Wedge**

**14SD**

- 14SD **Matrix Lifter Wedge Spring Box**, Borders and Dashes  
 14SD1 End  
 14SD2D\* Rod  
 14SD3† Rod Collar  
 14SD4 Rod Collar Taper Pin  
 14SD5 Rod Lock Nut

- 14SD6 Spring  
 14SD7 Yoke, to Matrix Cam Lever  
 14SD8 Yoke, to Wedge  
*X14SD* Matrix Lifter Wedge Spring Box, Borders and Dashes, group; consists of 14SD, 14SD1, 14SD2D, 14SD5 to 8 inclusive  
 \*14SD2D consists of 14SD2, 3 and 4  
 †Can be fitted only at Workshops

**17SD**

- b17SD **Lead Clamp Intermediate Lever Rod Yoke Pin**, to Mould

**18SD**

- 18SD **Lead Clamp Intermediate Lever Spring Box Rod End Pin**, to Matrix Cam Lever  
 18SD1 Nut  
*X18SD* Lead Clamp Intermediate Lever Spring Box Rod End Pin, to Matrix Cam Lever, group; consists of 18SD, 18SD1

**19SD**

- 19SDD\* **Lead Clamp Intermediate Lever Spring Box Yoke Pin**, to Lever  
 19SD1 Head (not supplied separately, order 19SDD)  
 19SD2 Screw,  $\frac{1}{8}'' \times \frac{1}{4}''$   
*X19SD* Lead Clamp Intermediate Lever Spring Box Yoke Pin, to Lever, group; consists of 19SDD, 19SD2  
 \*19SDD consists of 19SD, 19SD1

**20SD**

- 20SD\* **Matrix Lifter Wedge Spring Box Yoke Pin**, to Matrix Cam Lever, (not supplied separately, order X20SD)  
 20SD1\* Spring (not supplied separately, order X20SD)  
*X20SD* Matrix Lifter Wedge Spring Box Yoke Pin, to Matrix Cam Lifter, group; consists of 20SD, 20SD1

**21SD**

- 21SD **Matrix Lifter Wedge Spring Box Yoke Pin**, to Wedge  
 21SD1 Split Pin,  $\frac{1}{16}'' \times \frac{1}{2}''$   
*X21SD* Matrix Lifter Wedge Spring Box Yoke Pin, to Wedge, group; consists of 21SD, 21SD1



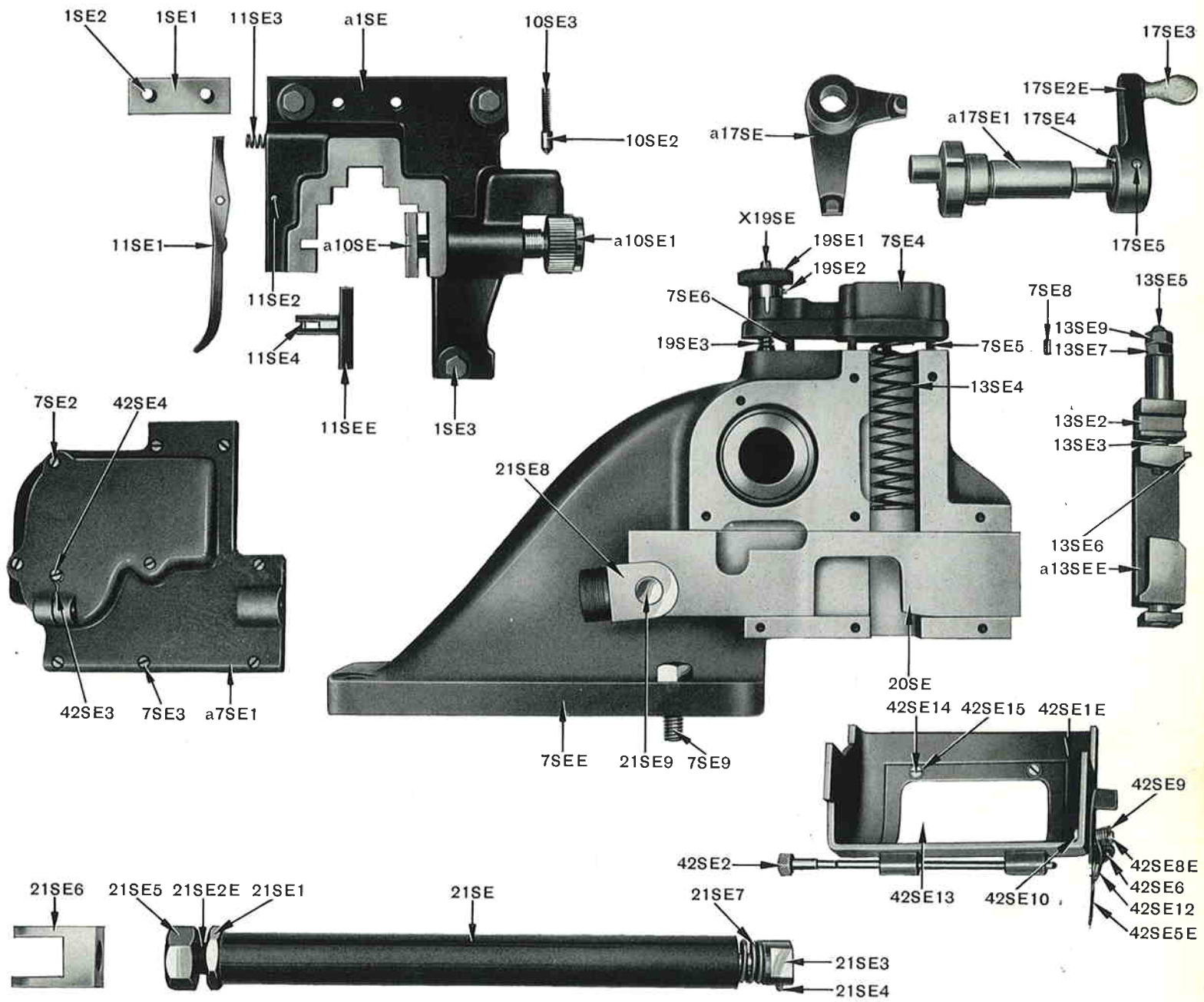

**4SD****Counter Bracket**

- 4SD6 Locating Key, front  
 4SD7 Locating Key Screw,  $\frac{1}{4}'' \times \frac{1}{2}''$

**6SD****Jet Block Driving Rod**

- a6SD3 Guide  
 a6SD4 Guide Screw (2),  $\frac{3}{16}'' \times \frac{7}{16}''$ , to Counter Bracket  
 6SD5 Spring  
 6SD6 Washer

**7SD****Jet Block Driving Rod Connection Rod**

- 7SD1 Lock Nut, left hand  
 7SD2 Lock Nut, right hand  
 a7SD3 Yoke, right hand, to Driving Rod  
 a7SD4 Yoke Pin  
 a7SD5 Yoke Pin, Split Pin,  $\frac{1}{16}'' \times \frac{1}{2}''$   
 7SD6 Yoke, left hand, to Type Carrier Cam Lever  
 a7SD7 Yoke Position Pin  
 7SD8 Yoke Position Pin Screw,  $\frac{3}{16}'' \times \frac{1}{4}''$   
*Xb7SD* Jet Block Driving Rod Connection Rod group; consists of 7SD, 7SD1 and 2, a7SD3 to 5 inclusive, 7SD6, a7SD7, 7SD8

**8SD****Lead Clamp Intermediate Lever**

- 8SD1 Fulcrum Pin, to Counter Bracket  
*Xa8SD* Lead Clamp Intermediate Lever group; consists of a8SD, 8SD1

**9SD****Lead Clamp Intermediate Lever Rod**

- b9SD Nut Lock Nut  
 a9SD1 Nut Lock Nut  
 a9SD2 Nut  
 b9SD4 Swivel  
 9SD5 Swivel Collar, lower  
 a9SD6 Swivel Circlip  
 9SD7 Swivel Washer  
 b9SD8 Yoke, to Mould  
 9SD9 Yoke Lock Nut  
 9SD11 Sleeve  
 9SD12 Spring  
 9SD15D\* Swivel Collar, upper  
 9SD16 Swivel Collar Pin  
 9SD18 Clip, for Rod Yoke Pin  
 9SD19 Clip Collar  
*Xd9SD* Lead Clamp Intermediate Lever group; consists of b9SD, a9SD1

- and 2, b9SD4, 9SD5, a9SD6, 9SD7, b9SD8, 9SD9, 9SD11 and 12, 9SD15D, 9SD18 and 19, b17SD  
 \*9SD15D consists of 9SD15 and 16

**10SD****Lead Clamp Intermediate Lever Spring Box**

- 10SD End  
 10SD1 End  
 10SD2D\* Rod  
 10SD3† Rod Collar  
 10SD4 Rod Collar Taper Pin,  $\frac{3}{32}'' \times \frac{1}{2}''$   
 10SD5 Rod End, to Matrix Cam Lever  
 10SD6 Rod End Lock Nut  
 10SD7 Spring  
 10SD8 Yoke, to Intermediate Lever  
*X10SD* Lead Clamp Intermediate Lever Spring Box group; consists of 10SD, 10SD1, 10SD2D, 10SD5 to 8 inclusive  
 \*10SD2D consists of 10SD2, 3 and 4  
 †Can be fitted only at Workshops

**11SD****Matrix Lifter, standard, Borders and Dashes (for type heights .918" to .9815")**

- 11SD Matrix Lifter, standard, Borders and Dashes (for type heights .918" to .9815")  
*a11SD* Matrix Lifter, special, Borders and Dashes (for type heights .960" to 1.017")

**12SD****Matrix Lifter Bracket**

- a12SD Screw,  $\frac{1}{2}'' \times 3''$ , hexagon, to Counter Bracket  
 a12SD1 Cover  
 12SD2 Cover Screw (6),  $\frac{3}{16}'' \times \frac{3}{8}''$   
 12SD3 Matrix Lifter Bracket group; consists of a12SD, a12SD1, 12SD2, 12SD3(6)  
*Xa12SD*

**13SD****Matrix Lifter Lock Wedge**

- 13SD Matrix Lifter Lock Wedge

**14SD****Matrix Lifter Wedge Spring Box, Borders and Dashes**

- 14SD End  
 14SD1 End  
 14SD2D\* Rod  
 14SD3† Rod Collar  
 14SD4 Rod Collar Taper Pin  
 14SD5 Rod Lock Nut

- 14SD6 Spring  
 14SD7 Yoke, to Matrix Cam Lever  
 14SD8 Yoke, to Wedge  
*X14SD* Matrix Lifter Wedge Spring Box, Borders and Dashes, group; consists of 14SD, 14SD1, 14SD2D, 14SD5 to 8 inclusive  
 \*14SD2D consists of 14SD2, 3 and 4  
 †Can be fitted only at Workshops

**17SD****Lead Clamp Intermediate Lever Rod Yoke Pin, to Mould**

- b17SD Lead Clamp Intermediate Lever Rod Yoke Pin, to Mould

**18SD****Lead Clamp Intermediate Lever Spring Box Rod End Pin, to Matrix Cam Lever**

- 18SD Nut  
 18SD1 Nut  
*X18SD* Lead Clamp Intermediate Lever Spring Box Rod End Pin, to Matrix Cam Lever, group; consists of 18SD, 18SD1

**19SD****Lead Clamp Intermediate Lever Spring Box Yoke Pin, to Lever**

- 19SD\* Head (not supplied separately, order 19SDD)  
 19SD1 Head (not supplied separately, order 19SDD)  
 19SD2 Screw,  $\frac{1}{8}'' \times \frac{1}{4}''$   
*X19SD* Lead Clamp Intermediate Lever Spring Box Yoke Pin, to Lever, group; consists of 19SD, 19SD2  
 \*19SDD consists of 19SD, 19SD1

**20SD****Matrix Lifter Wedge Spring Box Yoke Pin, to Matrix Cam Lever, (not supplied separately, order X20SD)**

- 20SD\* Spring (not supplied separately, order X20SD)  
 20SD1\* Matrix Lifter Wedge Spring Box Yoke Pin, to Matrix Cam Lifter, group; consists of 20SD, 20SD1  
*X20SD*

**21SD****Matrix Lifter Wedge Spring Box Yoke Pin, to Wedge**

- 21SD Split Pin,  $\frac{1}{16}'' \times \frac{1}{2}''$   
 21SD1 Matrix Lifter Wedge Spring Box Yoke Pin, to Wedge, group; consists of 21SD, 21SD1  
*21SD1*  
*X21SD*

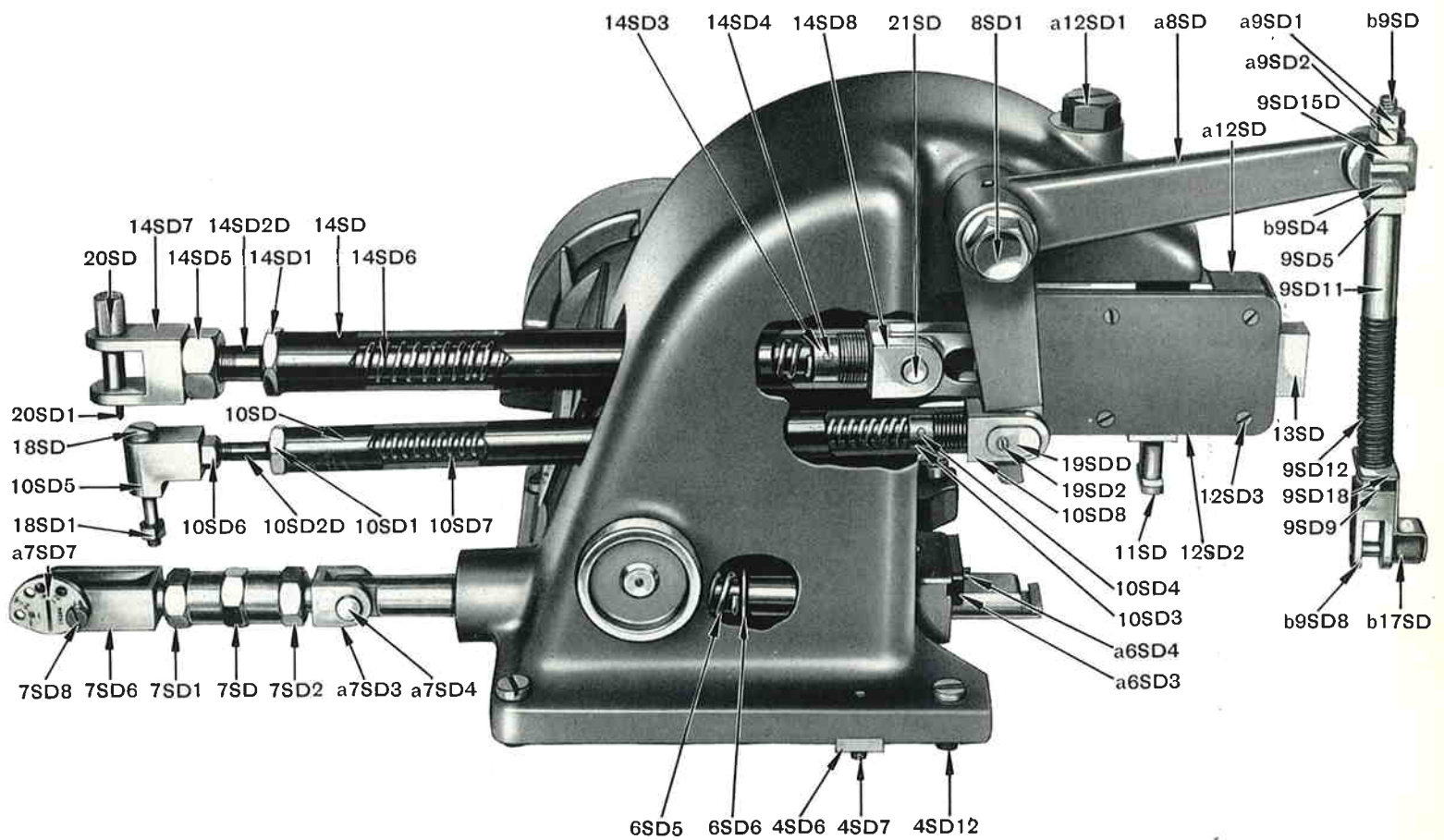



**1SD**

- a1SD* **Actuating Lever** (not supplied separately, order Xa1SD)  
 1SD1 Pin, Fulcrum for Pawl  
 1SD2 Spring Post  
*1SD4\** Link, to Blade Stop  
 a1SD5 Pin, for Link, Furniture Mould  
 Xa1SD Actuating Lever group; consists of a1SD, 1SD1 and 2, a1SD5  
 \*For use with Furniture Mould

**2SD**

- 2SD **Actuating Pawl**  
 2SD1 Spring  
 2SD2 Spring Post  
 2SD3 Trip Pin, in Counter Bracket  
 2SD4 Trip Pin Lock Nut  
*X2SD* Actuating Pawl group; consists of 2SD, 2SD1 to 4 inclusive

**4SD**

- b4SDD\* **Counter Bracket**  
 4SD1 Cover, for Drum (see Plate 20)  
 4SD2 Cover Screw (2),  $\frac{1}{8}'' \times \frac{15}{64}''$  (see Plate 20)  
 4SD3 Cover for Mechanism  
 4SD4 Cover Screw, long,  $\frac{3}{16}'' \times 1 \frac{13}{16}''$   
 4SD5 Cover Screw, short,  $\frac{3}{16}'' \times 1 \frac{7}{16}''$   
*4SD6* Locating Key, front (see Plate 18)  
 4SD7 Locating Key Screw,  $\frac{1}{4}'' \times \frac{1}{2}''$  (see Plate 18)  
 4SD8 Locating Key, rear  
 4SD9 Locating Key Dowel Pin  
 4SD10 Locating Key Screw,  $\frac{1}{4}'' \times \frac{9}{16}''$   
 4SD11 Pin, Stop for Drum Shaft Knob  
 4SD12 Screw (4),  $\frac{1}{8}'' \times \frac{7}{8}''$ , to Main Stand  
*Xb4SD* Counter Bracket group; consists of b4SDD, 4SD1, 4SD2(2), 4SD3 to 10 inclusive, 4SD12(4)  
*XX4SD* Counter Mechanism, specify height, complete, consists of Xa1SD, X2SD, Xb4SD, Xb5SD, Xb6SD, Xa8SD, Xd9SD, X10SD, 11SD or a11SD, Xa12SD, 13SD, X14SD, X15SD, Xa16SD, b17SD, X18SD, X19SD, X20SD, X21SD, X22SD, Xa23SD  
 \*b4SDD consists of b4SD, 4SD11, 15SD2

**6SD**

- b6SD **Jet Block Driving Rod**  
*a6SD3* Guide (see Plate 18)

- a6SD4* Guide Screw (2),  $\frac{3}{16}'' \times \frac{7}{16}''$ , to Counter Bracket (see Plate 18)  
 6SD5 Spring (see Plate 18)  
 6SD6 Washer (see Plate 18)  
*Xb6SD* Jet Block Driving Rod group; consists of b6SD, a6SD3, a6SD4(2), 6SD5 and 6

**15SD**

- 15SDD\* **Ratchet**  
 15SD1 Detent  
 15SD2 Detent Fulcrum Pin, in Counter Bracket  
 15SD3 Detent Fulcrum Pin Split Pin,  $\frac{1}{16}'' \times \frac{3}{8}''$   
 15SD4 Detent Spring  
 15SD5 Detent Spring Post, in Counter Bracket  
 15SD6 Detent Spring Post, in Detent Pin, anchor for Chain  
*15SD7*  
*X15SD* Ratchet group; consists of 15SDD, 15SD1 to 6 inclusive  
 \*15SDD consists of 15SD, 15SD7

**16SD**

- a16SD **Ratchet Stop Disc**  
 16SD1 Dowel Pin  
 16SD6 Screw (4),  $\frac{5}{32}'' \times \frac{3}{8}''$ , Ratchet to Disc  
*Xa16SD* Ratchet Stop Disc group; consists of a16SD, 16SD1, 16SD6(4)

**22SD**

- a22SDD\* **Stop Lever**  
 22SD1 Fulcrum Pin, to Counter Bracket  
 22SD2 Spring  
 22SD3 Spring Post, in Counter Bracket  
 22SD4 Spring Post  
*X22SD* Stop Lever group; consists of a22SDD, 22SD1, 2 and 3  
 \*a22SDD consists of a22SD, 22SD4

**23SD**

- Weight**  
 a23SD1D Chain to Ratchet Pin  
 23SD7 Hook

**32SU**

- Counter Mechanism and Equipment Attachment**  
 Object: To provide as Attachments, Counter

Mechanism and Equipment for Super Casters previously ordered without them  
 For Super Caster (Skeleton) not equipped with Composition Matrix Head and Equipment Attachment or Display Matrix Head and Equipment Attachment

- 32SU1 **Counter Mechanism and Equipment Attachment**; consists of Xa3SA, 1SD4, XX4SD, b5SF2, X20SG(2), Xa28SG, 12SH3, 12SH5, 12SH11, 12SH13, f13SHH, Xb19SH, Xa20SH, 18SL1(4), X21SL, 22SL1, Xb39SL, X45SL, X46SL, Xa47SL, 1ST1, 6ST3, 13ST9(2), 19ST1

For Super Casters equipped with Composition Matrix Head and Equipment Attachment

- 32SU2 **Counter Mechanism and Equipment Attachment**; consists of Xa3SA, 1SD4, XX4SD, b5SF2, X20SG(2), Xa28SG, 12SH3, 12SH5, 12SH11, 12SH13, Xa20SH, 18SL1(4), X21SL, Xb39SL, X45SL, X46SL, Xa47SL, 1ST1, 6ST3, 13ST9(2), 19ST1

For Super Casters equipped with Display Matrix Head and Equipment Attachment

- 32SU3 **Counter Mechanism and Equipment Attachment**; consists of 1SD4, XX4SD, b5SF2, X20SG(2), Xa28SG, 12SH5, 12SH11, 12SH13, Xe13SH, 18SL1(4), X21SL, Xb39SL, X45SL, X46SL, Xa47SL, 1ST1, 6ST3, 13ST9(2), 19ST1

For Super Casters equipped with Composition Matrix Head and Equipment Attachment and Display Matrix Head and Equipment Attachment

- 32SU4 **Counter Mechanism and Equipment Attachment**; consists of 1SD4, XX4SD, b5SF2, X20SG(2), Xa28SG, 12SH5, 12SH11, 12SH13, 18SL1(4), X21SL, Xb39SL, X45SL, X46SL, Xa47SL, 1ST1, 6ST3, 13ST9(2), 19ST1

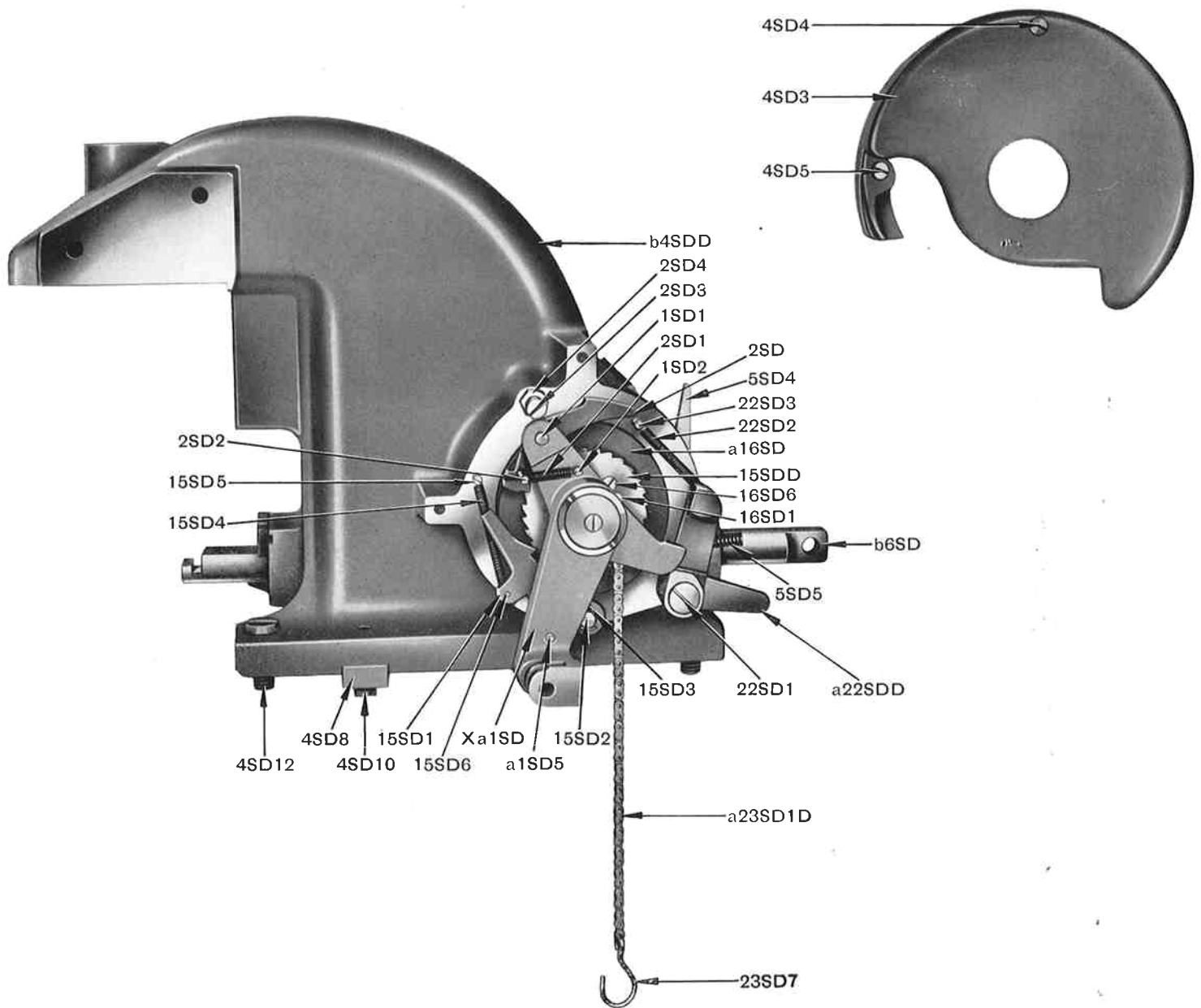

**4SD****Counter Bracket**

- 4SD1 Cover, for Drum  
 4SD2 Cover Screw (2),  $\frac{1}{8}'' \times \frac{15}{64}''$

**5SD****a5SDD\* Drum**

- a5SD1 Scale, fixed  
 5SD2 Scale (fixed) Screw (3),  $\frac{1}{8}'' \times \frac{5}{16}''$ , to Counter Bracket  
 5SD4 Latch  
 5SD5 Latch Spring  
 5SD6† Scale  
 5SD7 Scale Screw (10)  
 5SD8† Shaft

- 5SD9 Shaft End Plate  
 5SD10 Shaft End Plate Screw,  $\frac{3}{16}'' \times \frac{7}{16}''$   
 5SD11D†† Shaft Knob  
 5SD12 Shaft Knob Stop Pin  
 5SD13 Shaft Knob Taper Pin,  $\frac{3}{16}'' \times 1\frac{1}{2}''$   
 5SD14 Shaft Taper Pin,  $\frac{11}{64}'' \times 1\frac{1}{4}''$   
 5SD15 Stop, for Ratchet  
 5SD16 Stop Screw,  $\frac{5}{32}'' \times \frac{1}{2}''$

*Xb5SD* Drum group; consists of a5SDD, a5SD1, 5SD2(3), 5SD4 and 5, 5SD9 and 10

\*a5SDD consists of a5SD, 5SD6, 5SD7(10), 5SD8, 5SD11D, 5SD13 to 16 inclusive

†5SD11D consists of 5SD11 and 12

‡Can be fitted only at Workshops

**23SD****a23SD Weight**

a23SD1D\* Chain to Ratchet Pin (see Plate 19)

- 23SD2 Plug  
 23SD3D† Rod  
 23SD4 Rod Washer  
 23SD5 Spring  
 23SD7 Hook (see Plate 19)

*Xa23SD* Weight group; consists of a23SD, a23SD1D, 23SD2, 23SD3D, 23SD5

\*a23SD1D consists of a23SD1, 23SD7

†23SD3D consists of 23SD3 and 4





**5SF**  
 5SFF\* **Mould Blade Slide Drive Lever**  
 a5SF1 Intermediate Lever  
 5SF2 Plate  
 b5SF2 Plate, for use with Furniture Mould  
 5SF3 Plate Screw (2),  $\frac{5}{16}'' \times \frac{3}{4}''$   
 b5SF4 Plunger, in Intermediate Lever  
 a5SF5§ Plunger Lock Pin  
 a5SF6 Plunger Lock Pin Bush  
 5SF7§ Plunger Lock Pin Knob  
 5SF8 Plunger Lock Pin Spring  
 5SF9 Plunger Lock Pin Knob Taper Pin  
 b5SF11 Plunger Spring  
 a5SF12F† Plunger Spring Guide Rod  
 5SF13 Plunger Spring Abutment Collar  
 5SF14 Plunger Spring Guide Rod Pin to Lever  
 5SF15 Plunger Spring Guide Rod Pin Split Pin,  $\frac{1}{16}'' \times \frac{1}{2}''$   
 5SF16 Plunger Lever  
 5SF17 Plunger Lever Fulcrum Pin  
 a5SF18F‡ Plunger Lever Fulcrum Pin, eccentric

5SF19 Plunger Lever Fulcrum Pin Plunger  
 5SF20 Plunger Lever Fulcrum Pin Spring  
 5SF21 Plunger Lever Fulcrum Pin Retaining Screw,  $\frac{5}{16}'' \times \frac{1}{4}''$   
 5SF23§ Plunger Spring Adjusting Nut  
 5SF24§ Plunger Spring Guide Rod Stop Collar, for Plunger Spring Adjusting Nut  
 5SF25 Plunger Spring Guide Rod Stop Collar Rivet  
 5SF26 Plunger Lever Fulcrum Pin Handle  
 5SF27 Oiling Pad  
 Xa5SF Mould Blade Slide Drive Lever group; consists of 5SFF, a5SF1, 5SF2, 5SF3(2), b5SF4, a5SF5 and 6, 5SF7, 8 and 9, b5SF11, a5SF12F, 5SF13 to 17 inclusive, a5SF18F, 5SF19, 20 and 21  
 \*5SFF consists of 5SF, 5SF27  
 †a5SF12F consists of a5SF12, 5SF23, 24 and 25  
 ‡a5SF18F consists of a5SF18, 5SF26  
 §Can be fitted only at Workshops

**6SF**  
 6SF **Mould Blade Slide Drive Lever Connecting Tube**  
 a6SF Mould Blade Slide Driving Lever Connecting Tube, SCRIPT MOULD ATTACHMENT  
 6SF1F\* Ball End, to Mould Blade Slide Lever  
 6SF2 Ball End Nut  
 6SF3 Ball End Snug Pin  
 6SF4 Ball Socket, right hand, for 6SF1F  
 6SF5 Ball Socket Plug  
 6SF6 Ball Socket Plug Lock Nut  
 6SF7 Ball Socket, left hand, for Mould Blade Cam Lever Ball End  
 6SF8 Ball Socket Plug  
 6SF9 Ball Socket Plug Lock Nut  
 6SF10 Lock Nut, left hand  
 6SF11 Lock Nut, right hand  
 X6SF Mould Blade Slide Drive Lever Connecting Tube group; consists of 6SF, 6SF1F, 6SF2, 6SF4 to 11 inclusive  
 \*6SF1F consists of 6SF1, 6SF3

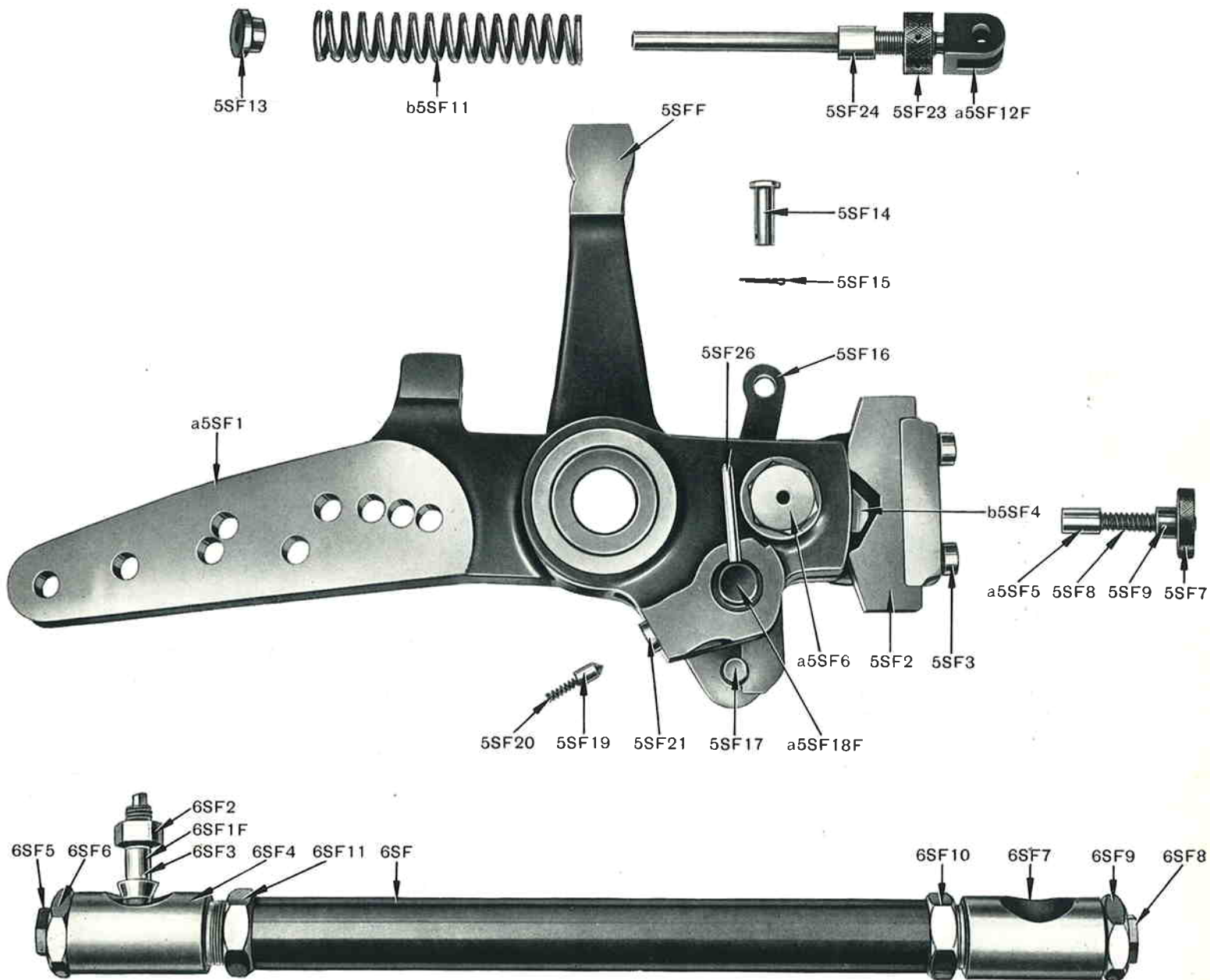

**3SL**

- a3SL* **Matrix Holder**, for .2" Matrices (.050" Drive) (not supplied separately, order Xa3SL)
- a3SL1* Handle
- 3SL2* Handle Screw (2),  $\frac{5}{32}'' \times \frac{13}{32}''$ , to Holder
- 3SL3* Handle Screw Spring Washer (2)
- a3SL11*† Matrix Retainer
- a3SL11 assd.\** Matrix Retainer, assembled
- a3SL12* Matrix Squaring Plunger, left hand
- a3SL13* Matrix Squaring Plunger, right hand
- a3SL14L*†‡ Guide Plate
- 3SL15* Guide Plate Screw (6),  $\frac{3}{32}'' \times \frac{7}{64}''$ , countersunk to Holder
- 3SL16* Matrix Squaring Plunger Lever (2)
- 3SL17* Matrix Squaring Plunger Lever Pin (2)
- a3SL18* Matrix Squaring Plunger Lever Spring
- a3SL19* Matrix Squaring Plunger Lever Spring Support Wire
- 3SL26* Handle Plate
- 3SL27*† Matrix Retainer Knob
- 3SL28* Matrix Retainer Knob Pin
- 3SL29*† Matrix Retainer Safety Plate
- 3SL30* Matrix Retainer Safety Plate Pin
- 3SL31*† Matrix Retainer Spring
- 3SL32*† Matrix Retainer Spring Abutment
- Xa3SL* Matrix Holder, .2" Matrices (.050" Drive) group; consists of *a3SL*, *a3SL1*, *3SL2(2)*, *3SL3(2)*, *a3SL11 assd.*, *a3SL12* and *13*, *a3SL14L*, *3SL15(6)*, *3SL16(2)*, *3SL17(2)*, *a3SL18* and *19*, *3SL26*
- Xb3SL* Matrix Holder, .2" Matrices (.030" Drive) group; consists of *Xa3SL* modified
- \**a3SL11 assd.* consists of *a3SL11*, *3SL27* to *31* inclusive
- †*a3SL14L* consists of *a3SL14*, *3SL32*
- ‡Can be fitted only at Workshops

**4SL**

- a4SL* **Matrix Holder**, .2" Extended Matrices (.050" Drive) (not supplied separately, order Xa4SL)
- a4SL1*† Cover
- 4SL2* Cover Screw (4),  $\frac{3}{32}'' \times \frac{7}{64}''$ , countersunk to Holder
- a4SL3* Handle
- a4SL4* Handle Screw (2),  $\frac{5}{32}'' \times \frac{5}{16}''$ , countersunk to Holder
- 4SL6* Matrix Locating Block
- 4SL7* Matrix Locating Block Retaining Screw
- 4SL8* Matrix Wire (3)
- 4SL9L*\* Matrix Wire and Plate
- 4SL10* Matrix Wire Plate Retaining Plunger (2)
- 4SL11* Matrix Wire Plate Retaining Plunger Spring (2)
- 4SL12* Handle Packing Piece (2), heat insulating
- 4SL13* Matrix Locating Block Packing (.2" x .4")
- 4SL14* Matrix Locating Block Packing (.2" x .1") (2)
- Xa4SL* Matrix Holder, .2" Extended Matrices (.050" Drive) group; consists of *a4SL*, *a4SL1*, *4SL2(4)*, *a4SL3*, *a4SL4(2)*, *4SL6* and *7*, *4SL9L*, *4SL10(2)*, *4SL11(2)*, *4SL12(2)*, *4SL13*, *4SL14(2)*
- Xb4SL* Matrix Holder, .2" Extended Matrices (.030" Drive) group; consists of *Xa4SL* modified
- \**4SL9L* consists of *4SL8(3)*, *4SL9*
- †Can be fitted only at Workshops

**5SL**

- a5SL* **Matrix Holder**, .4" Matrices (.050" Drive) (not supplied separately, order Xa5SL)
- b5SL* **Matrix Holder**, .4" and .4" Extended or Flanged 'Monotype' Thompson Matrices (not supplied separately, order Xc5SL)
- a5SL1L*\*¶ Guide Plate
- b5SL1L*†¶ Guide Plate
- 5SL2* Guide Plate Screw (6),  $\frac{3}{32}'' \times \frac{7}{64}''$ , countersunk to Holder
- a5SL3* Handle
- b5SL3* Handle
- 5SL4* Handle Screw (2),  $\frac{5}{32}'' \times \frac{13}{32}''$ , to Holder
- 5SL5* Handle Screw Spring Washer (2)
- a5SL6*¶ Matrix Retainer
- a5SL6 assd.‡* Matrix Retainer, assembled
- b5SL6*¶ Matrix Retainer
- b5SL6 assd.§* Matrix Retainer, assembled
- 5SL11* Handle Packing Piece (2), heat insulating
- 5SL12* Handle Plate
- a5SL12* Handle Plate
- 5SL13*¶ Matrix Retainer Knob
- 5SL14* Matrix Retainer Knob Pin
- 5SL15*¶ Matrix Retainer Safety Plate
- a5SL15*¶ Matrix Retainer Safety Plate
- 5SL16* Matrix Retainer Safety Plate Locating Pin (2)
- 5SL17*¶ Matrix Retainer Spring
- 5SL18*¶ Matrix Retainer Spring Abutment
- 5SL19*¶ Matrix Retainer Spring Abutment Washer
- 5SL20* Bush
- 5SL21* Matrix Locator
- 5SL22* Matrix Locator Spring
- Xa5SL* Matrix Holder, .4" Matrices (.050" Drive) group; consists of *a5SL*, *a5SL1L*, *5SL2(6)*, *a5SL3*, *5SL4(2)*, *5SL5(2)*, *a5SL6 assd.*, *5SL11(2)*, *5SL12*
- Xb5SL* Matrix Holder, .4" Matrices (.030" Drive) group; consists of *Xa5SL* modified
- Xc5SL* Matrix Holder, .4" and .4" Extended or Flanged 'Monotype' Thompson Matrices, group; consists of *b5SL*, *b5SL1L*, *5SL2(6)*, *b5SL3*, *5SL4(2)*, *5SL5(2)*, *b5SL6 assd.*, *5SL11(2)*, *a5SL12*, *5SL20*, *21* and *22*. ORDER BY ATTACHMENT SYMBOL 28SU1
- \**a5SL1L* consists of *a5SL1*, *5SL18*
- †*b5SL1L* consists of *b5SL1*, *5SL18*
- ‡*a5SL6 assd.*, consists of *a5SL6*, *5SL13*, *14* and *15*, *5SL16(2)*, *5SL17*, *5SL19*
- §*b5SL6 assd.*, consists of *b5SL6*, *5SL13* and *14*, *a5SL15*, *5SL16* and *17*, *5SL19*
- ¶Can be fitted only at Workshops
- 58SL**
- THIN SPACE CUTTER ATTACHMENT**
- b58SL1* Blade Guide, Attachment a29SU1
- c58SL1* Blade Guide, Attachment a29SU2
- 58SL2*\* Body
- 58SL3* Body Cover Plate
- 58SL4* Body Cover Plate Screw (2),  $\frac{1}{8}'' \times \frac{3}{16}''$
- a58SL5* Cutter Blade
- 58SL6*\* Cutter Blade Slide
- 58SL7* Cutter Blade Screw,  $\frac{1}{4}'' \times \frac{7}{16}''$
- 58SL8*\* Driving Shaft
- 58SL9* Driving Shaft Handwheel
- 58SL10* Driving Shaft Handwheel Handle
- 58SL11* Driving Shaft Handwheel key
- 58SL12* Driving Shaft Handwheel Nut

- 58SL13* Driving Shaft Handwheel Washer
- a58SL14* Pusher Blade
- 58SL15* Pusher Blade Screw
- 58SL16* Pusher Blade Spring
- 58SL17* Pusher Blade Weight
- 58SL18* Setting Slide
- 58SL19* Setting Slide Spring
- 58SL20* Setting Slide Spring Guide Plate
- 58SL21* Setting Slide Spring Guide Plate (2),  $\frac{3}{16}'' \times \frac{1}{16}''$
- 58SL22* Setting Slide Stop Screw,  $\frac{5}{32}'' \times \frac{3}{4}''$ , grub
- 58SL23* Setting Slide Stop Screw Lock Nut
- 58SL24* Setting Slide Stud, in Body
- 58SL25* Setting Slide Wing Nut
- 58SL26* Setting Slide Wing Nut Washer
- 58SL27* Shear Block
- 58SL28* Shear Block Screw (2),  $\frac{1}{4}'' \times 1''$
- 58SL29* Shear Block Washer (2)
- b58SL30* Strip Feed Guide, Attachment a29SU1
- c58SL30* Strip Feed Guide, Attachment a29SU2
- 58SL31* Strip Feed Guide Screw,  $\frac{1}{4}'' \times \frac{1}{2}''$
- 58SL32*\* Cutter Blade Slide Link
- 58SL33*\* Cutter Blade Slide Link Pin
- Xc58SL* Thin Space Cutter group; consists of *b58SL1*, *58SL2* and *3*, *58SL4(2)*, *a58SL5*, *58SL6* to *13* inclusive, *a58SL14*, *58SL15* to *20* inclusive, *58SL21(2)*, *58SL22* to *27* inclusive, *58SL28(2)*, *58SL29(2)*, *b58SL30*, *58SL31*, *32* and *33*
- ORDER BY ATTACHMENT SYMBOL a29SU1
- Xd58SL* Thin Space Cutter group; consists of *c58SL1*, *58SL2* and *3*, *58SL4(2)*, *a58SL5*, *58SL6* to *13* inclusive, *58SL14*, *58SL15* to *20* inclusive, *58SL21(2)*, *58SL22* to *27* inclusive, *58SL28(2)*, *58SL29(2)*, *c58SL30*, *58SL31*, *32* and *33*
- ORDER BY ATTACHMENT SYMBOL a29SU2
- \*Can be fitted only at Workshops

**28SU**

**Matrix Holder .4" 'Monotype' Thompson Matrices Attachment**  
Object: To provide Matrix Holder for .4" and .4" Extended 'Monotype' Thompson Matrices for use on the Super Caster

*28SU1* **Matrix Holder .4" 'Monotype' Thompson Matrices Attachment;** consists of *Xc5SL*

Note: This Holder is suitable also for .4" 'Monotype' Thompson Matrices, flanged

**29SU**

**Thin Space Cutter Attachment**  
Object: To produce Thin Spaces from 1, 1½, 2 and 3 point and didot and up to .928" as standard, over .928" as special pre-cast Leads (up to 18" in length) in body sizes from 4½ to 72 point and didot  
For Lead Heights up to and including .928"

*a29SU1* **Thin Space Cutter Attachment;** consists of *Xc58SL*

For Lead Heights over .928"

*a29SU2* **Thin Space Cutter Attachment;** consists of *Xd58SL*

Note: This mechanism is for use on a Bench



5SL5



5SL4

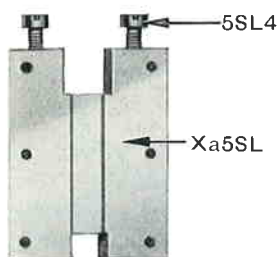

5SL13

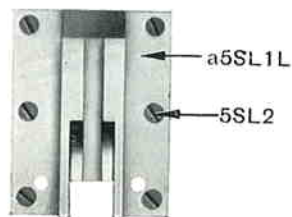

a4SL3



a4SL4

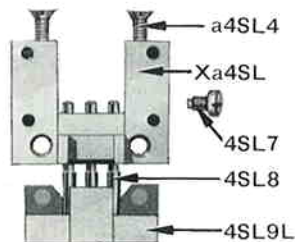

4SL10

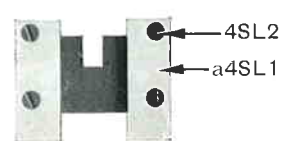

a3SL1

3SL3



a3SL13

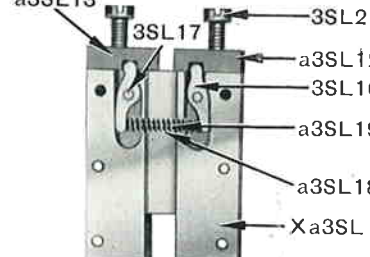

3SL27

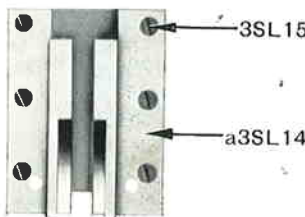



**6SL**

- a6SLL\* **Matrix Holder**, 1" x 1", 1" x 1 1/8", 1" x 1.35" Display Matrices  
 b6SLL† **Matrix Holder**, 1" x 1" Display Matrices  
 No. 70826 Blank Matrix, 1" x 1"  
 a6SL1 Handle  
 a6SL2 Handle Screw (2), 3/16" x 1/2"  
 6SL3‡ Matrix Adjusting Screw  
 6SL4 Matrix Adjusting Screw Lock Plunger, in Handle  
 6SL5 Matrix Adjusting Screw Lock Plunger Spring  
 6SL6‡ Matrix Clamp  
 a6SL6‡ Matrix Clamp  
 6SL7 Matrix Clamp Pin  
 6SL8‡ Matrix Clamp Shaft  
 a6SL9‡ Matrix Clamp Spring  
 6SL10‡ Matrix Locator  
 a6SL10‡ Matrix Locator  
 6SL11‡ Matrix Locator Spring  
 6SL13‡ Insert  
 6SL14 Insert Screw (2), 1/8" x 15/64", to Holder  
 6SL15 Handle Washer (2), heat insulating  
 Xa6SL Matrix Holder, 1" x 1", 1" x 1 1/8", 1" x 1.35" Display Matrices, group; consists of a6SLL and 70826  
 Xb6SL§ Matrix Holder, 1" x 1" Display Matrices, group; consists of b6SLL and 70826  
 \*a6SLL consists of a6SL, a6SL1, a6SL2(2), 6SL3 to 8 inclusive, a6SL9, 6SL10 and 11, 6SL13, 6SL14(2), 6SL15(2)  
 †b6SLL consists of b6SL, a6SL1, a6SL2(2), 6SL3, 4 and 5, a6SL6, 6SL7 and 8, a6SL9 and 10, 6SL11, 6SL15(2)  
 ‡Can be fitted only at Workshops  
 §Used for series 549 - 48 Didot

**7SL**

- a7SLL\* **Matrix Holder**, 1 1/8" x 1 1/8", 1 1/8" x 1.35" Display Matrices  
 b7SLL† **Matrix Holder**, 1 1/8" x 1 1/8" Display Matrices  
 No. 70827 Blank Matrix, 1 1/8" x 1 1/8"  
 a7SL1 Handle  
 a7SL2 Handle Screw (2), 3/16" x 1/2"  
 7SL3‡ Matrix Adjusting Screw  
 7SL4 Matrix Adjusting Screw Lock Plunger, in Handle  
 7SL5 Matrix Adjusting Screw Lock Plunger Spring  
 7SL6‡ Matrix Clamp  
 a7SL6‡ Matrix Clamp  
 7SL7 Matrix Clamp Pin  
 7SL8‡ Matrix Clamp Shaft  
 a7SL9‡ Matrix Clamp Spring  
 7SL10‡ Matrix Locator  
 a7SL10‡ Matrix Locator

- 7SL11‡ Matrix Locator Spring  
 7SL13‡ Insert  
 7SL14 Insert Screw (2), 1/8" x 15/64", to Holder  
 7SL15 Handle Washer (2), heat insulating  
 Xa7SL Matrix Holder, 1 1/8" x 1 1/8", 1 1/8" x 1.35" Display Matrices, group; consists of a7SLL and 70827  
 Xb7SL§ Matrix Holder, 1 1/8" x 1 1/8" Display Matrices, group; consists of b7SLL and 70827  
 \*a7SLL consists of a7SL, a7SL1, a7SL2(2), 7SL3 to 8 inclusive, a7SL9, 7SL10 and 11, 7SL13, 7SL14(2), 7SL15(2)  
 †b7SLL consists of b7SL, a7SL1, a7SL2(2), 7SL3, 4 and 5, a7SL6, 7SL7 and 8, a7SL9 and 10, 7SL11, 7SL15(2)  
 ‡Can be fitted only at Workshops  
 §Used for Series 559 - 54 Didot

**8SL**

- 8SLL\* **Core Block Holder**, Low Space Blanks and Quotation Cores, type heights .918" and .9273" (specify quotation height)  
 a8SLL† **Core Block Holder**, Low Space Blanks and Quotation Cores, type heights .918" to 1.017" inclusive (specify type and quotation heights)  
 a8SL1 Handle  
 a8SL2 Handle Screw (2), 3/16" x 1/2"  
 8SL3‡ Matrix Adjusting Screw  
 8SL4 Matrix Adjusting Screw Lock Plunger, in Handle  
 8SL5 Matrix Adjusting Screw Lock Plunger Spring  
 8SL6‡ Matrix Clamp  
 8SL7 Matrix Clamp Pin  
 8SL8‡ Matrix Clamp Shaft  
 a8SL9‡ Matrix Clamp Spring  
 8SL10‡ Matrix Locator, 1/2" diameter  
 a8SL10‡ Matrix Locator, 15/32" diameter  
 8SL11‡ Matrix Locator Spring  
 8SL18 Handle Washer (2), heat insulating  
 No. 8708 Low Space Blank  
 No. 8709 Quotation Core, specify sizes  
 Xb8SL **Core Block Holder**, for Wooden Cored Quotations (Quotation Height .750" to .860" inclusive) group; consists of b8SL, a8SL1, a8SL2(2), 8SL3 to 8 inclusive, a8SL9 and 10, 8SL11, 8SL18(2)  
 \*8SLL consists of 8SL, a8SL1, a8SL2(2), 8SL3 to 8 inclusive, a8SL9, 8SL10 and 11, 8SL18(2)  
 †a8SLL consists of a8SL, a8SL1, a8SL2(2), 8SL3 to 8 inclusive, a8SL9, 8SL10 or a8SL10, 8SL11, 8SL18(2)  
 ‡Can be fitted only at Workshops

**9SL**

- a9SL **Matrix Holder**, Continuous Border Matrices (not supplied separately, order Xa9SL)  
 a9SL1 Matrix Sealing Plunger Abutment  
 9SL2 Matrix Sealing Plunger Abutment Screw, 1/8" x 7/16"  
 9SL3\* Matrix Clamp  
 9SL4\* Matrix Clamp Spring  
 9SL5 Matrix Clamp Spring Pin, in Clamp  
 9SL6\* Matrix Clamp Spring Pin, in Holder  
 9SL7 Matrix Sealing Plunger  
 9SL8 Matrix Sealing Plunger Knob  
 9SL9 Matrix Sealing Plunger Pin  
 9SL10 Matrix Sealing Plunger Spring  
 Xa9SL **Matrix Holder**, Continuous Border Matrices, group; consists of a9SL, a9SL1, 9SL2 to 10 inclusive  
 \*Can be fitted only at Workshops

**10SL**

- 10SL1 **Matrix Holder**, Dash Matrices, Standard (.030" drive)  
 a10SL1 **Matrix Holder**, Dash Matrices, Special (.065" drive)

**11SL**

- 11SL1 **Matrix Holder Box**

**53SL**

- 53SL1L\* **Matrix Holder**  
 No. 70826 Blank Matrix, 1" x 1"  
 53SL2 Handle  
 53SL3 Handle Screw (2), 3/16" x 1/2"  
 53SL4 Handle Washer (2), Heat Insulating  
 53SL5‡ Insert  
 53SL6 Insert Screw (2), 1/8" x 15/64", to Holder  
 53SL7‡ Matrix Adjusting Screw  
 53SL8 Matrix Adjusting Screw Lock Plunger, in Handle  
 53SL9 Matrix Adjusting Screw Lock Plunger Spring  
 53SL10‡ Matrix Clamp  
 53SL11 Matrix Clamp Pin  
 53SL12‡ Matrix Clamp Shaft  
 53SL13‡ Matrix Clamp Spring  
 53SL14‡ Matrix Locator  
 53SL15‡ Matrix Locator Spring  
 \*53SL1L consists of 53SL1 and 2, 53SL3(2), 53SL4(2), 53SL5, 53SL6(2), 53SL7 to 15 inclusive  
 ‡Can be fitted only at Workshops

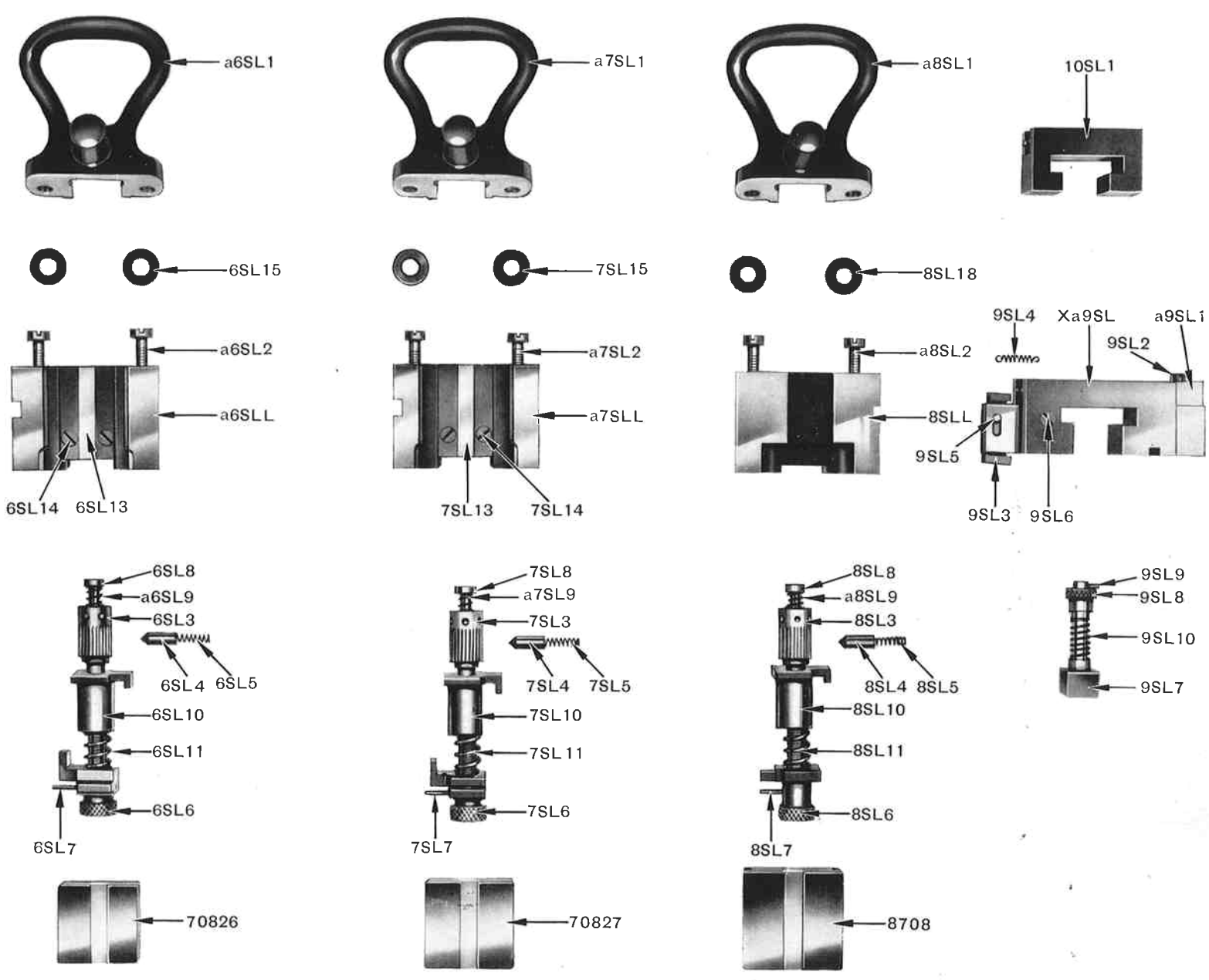

**39SE****ADAPTOR BASE ATTACHMENT**

39SE1 **Mould Coupling Hook**, 14-48 point and didot, used also for Adaptor Base for Display Mould so that only one part is required if both Adaptor Bases are supplied

**14SL**

14SL1 **Mould Clamp** (2)

**17SL**

b17SL1 **Mould Screw** (3), Type Moulds

**18SL**

18SL1 **Mould Screw** (4),  $\frac{3}{8}'' \times 1\frac{5}{16}''$ , Lead Moulds

**23SL**

b23SLL\* **Adaptor Base**

c23SLL† **Adaptor Base**

d23SLL‡ **Adaptor Base Attachment d1SU**

23SL1|| **Clamp Pad** (5)

b23SL2§ **Screw**, long,  $\frac{1}{4}'' \times 1\frac{9}{16}''$ , through Main Stand and Adaptor Base to Mould

b23SL3§ **Screw**, short,  $\frac{1}{4}'' \times 1\frac{1}{8}''$ , through Main Stand and Adaptor Base to Mould

—¶ **Screw**,  $\frac{1}{4}'' \times \frac{15}{16}''$ , through Main Stand to Adaptor Base

23SL4§ **Screw**,  $\frac{1}{4}'' \times \frac{15}{16}''$ , to Intermediate Plate, Mould to Adaptor Base

23SL5 **Screw**, Mould Locating  
23SL7 **Screw**, Mould Locating, ADAPTOR BASE ATTACHMENT 2SU

23SL8 **Seating Plate**, for Bridge (Display Matrix), ADAPTOR BASE ATTACHMENT 2SU

23SL9 **Seating Plate Screw** (2),  $\frac{3}{16}'' \times \frac{5}{16}''$ , to Base, ADAPTOR BASE ATTACHMENT 2SU

23SL10 **Seating Plate Screw**,  $\frac{1}{4}'' \times \frac{7}{8}''$ , hexagon, to Bridge, ADAPTOR BASE ATTACHMENT 2SU

23SL11 **Clamp Plate**, ADAPTOR BASE ATTACHMENT d1SU

23SL12 **Clamp Plate Screw**,  $\frac{1}{8}'' \times \frac{5}{16}''$ , ADAPTOR BASE ATTACHMENT d1SU

23SL13 **Jet Deflector**, ADAPTOR BASE ATTACHMENT d1SU

23SL14 **Jet Deflector Screw**,  $\frac{5}{32}'' \times \frac{1}{2}''$ , ADAPTOR BASE ATTACHMENT d1SU

23SL15 **Lever L.Q. Setting Screw**, ADAPTOR BASE ATTACHMENT d1SU

23SL16 **Lever L.Q. Bracket**, ADAPTOR BASE ATTACHMENT d1SU

23SL17 **Lever L.Q. Lock Nut**, ADAPTOR BASE ATTACHMENT d1SU

Xb23SL **Adaptor Base group**; consists of b23SLL, b23SL2 and 3, 23SL4 and 5, X25SL, X31SL

Xc23SL **Adaptor Base**, ADAPTOR BASE ATTACHMENT 2SU, group; consists of c23SLL, b23SL2 and 3, 23SL4, 23SL7 and 8, 23SL9(2), 23SL10, Xb31SL

Xd23SL **Adaptor Base**, ADAPTOR BASE ATTACHMENT d1SU, group; consists of d23SLL, b23SL2 and 3, 23SL4 and 5, 23SL13 to 17 inclusive, 25SL3(2), X31SL

\*b23SLL consists of b23SL, 23SL1(5)

†c23SLL consists of c23SL, 23SL1(5)

‡d23SLL consists of d23SL, 23SL1(4), 23SL11 and 12

§Used also for Adaptor Base for Composition Moulds (see Attachment 1SU) so that only ONE of these parts is required if both Adaptor Bases are supplied

¶Use one of the three Screws b17SL1 and the Wrench a13ST8

||Can be fitted only at Workshops

**24SL**

24SL1 **Adaptor Base Clamp** (2)

**25SL**

25SL **Low Quad Lever Spring**

25SL1 **Lever**

a25SL2† **Lever Bracket**

a25SL2 assd.\* **Lever Bracket**, assembled

25SL3 **Lever Bracket Screw** (2),  $\frac{1}{4}'' \times \frac{1}{2}''$ , to Adaptor Base

a25SL4† **Lever Fulcrum Pin**

25SL5 **Lever Fulcrum Pin Keep Pin**

25SL6 **Post**, in Lever

25SL7 **Plate**, long

25SL8 **Plate**, short

X25SL **Low Quad Lever Spring group**; consists of a25SL2 assd., 25SL3(2)

\*a25SL2 assd. consists of 25SL, 25SL1, a25SL2, a25SL4, 25SL5 to 8 inclusive

†Can be fitted only at Workshops

**31SL**

31SL **Type Clamp Operating Block**, 5-13 point and didot, ADAPTOR BASE ATTACHMENTS 1SU, a1SU, c1SU

a31SL **Type Clamp Operating Block**, 14-24 point and didot, ADAPTOR BASE ATTACHMENTS 1SU1, a1SU1, b1SU1, 1SU5, a1SU5, c1SU5, d1SU5, e1SU5, 1SU7, a1SU7, b1SU7

b31SL **Type Clamp Operating Block**, 14-36 point and didot

c31SL **Type Clamp Operating Block**, 42-48 point and didot

d31SL **Type Clamp Operating Block**, Short Lead and Rule Mould, ADAPTOR BASE ATTACHMENT 1SU4, a1SU4

31SL2 **Screw** (2),  $\frac{3}{16}'' \times \frac{11}{16}''$ , to Adaptor Base, ADAPTOR BASE ATTACHMENTS 1SU, 1SU1, 1SU4, 1SU5, a1SU5, e1SU5, 1SU7, a1SU7, b1SU7

31SL5 **Screw** (2),  $\frac{3}{16}'' \times \frac{13}{16}''$ , to Adaptor Base

X31SL **Type Clamp Operating Block**, 5-13 point and didot group; consists of 31SL, 31SL2(2)

Xa31SL\* **Type Clamp Operating Block**, 14-24 point and didot, ADAPTOR BASE ATTACHMENTS 1SU1, 1SU5, a1SU5, group; consists of a31SL, 31SL2(2)

Xb31SL **Type Clamp Operating Block**, 14-36 point and didot, group; consists of b31SL, 31SL5(2)

Xc31SL **Type Clamp Operating Block**, 42-48 point and didot, group; consists of c31SL, 31SL5(2)

Xd31SL **Type Clamp Operating Block**, Short Lead and Rule Mould, ADAPTOR BASE ATTACHMENT a1SU4, 1SU4, group; consists of d31SL, 31SL2(2)

\*Used for Adaptor Bases for both Large Composition and Duplex Moulds so that only ONE part is required if both Adaptor Bases are supplied

**59SL****ADAPTOR BASE ATTACHMENTS**

59SL1 **Mould Blade (Auxiliary, large) Lever Spring**

59SL2 **Lever**

59SL3† **Lever Bracket**

59SL3 assd.\* **Lever Bracket**, assembled

59SL4† **Lever Bracket Screw** (2),  $\frac{1}{4}'' \times \frac{1}{2}''$ , to Adaptor Base

59SL5† **Lever Fulcrum Pin**

59SL6 **Lever Fulcrum Pin Keep Pin**

59SL7 **Plate**, long

59SL8 **Plate**, short

59SL9 **Post**, in Lever

59SL10 **Mould Blade (Auxiliary, small) Lever Spring**

59SL11 **Plate** (2)

59SL12 **Post** (2), in Bracket and Mould

59SL13 **Post**, in Mould Blade Lever

\*59SL3 assd. consists of 59SL2 and 3, 59SL5 and 6

†For Super Casters numbered 70492 and over, use the two Screws 25SL3 supplied as part of the Super Caster equipment

‡Can be fitted only at Workshops

**1SU****Adaptor Base Attachment**

Object: To enable Composition Moulds up to and including the 100,000 Series, also the Quad, Large Composition, Short Lead and Rule, Duplex and Triplex Moulds to be used on the Super Caster

For use with Large Composition  
Moulds on Super Casters  
numbered 70492 and onwards

*a1SU1* **Adaptor Base Attachment**; consists of  
39SE1, a31SL

For use with Short Lead and Rule  
Moulds on Super Casters  
numbered 70492 and onwards

*a1SU4* **Adaptor Base Attachment**; consists of  
12SH12, d31SL

For use with Duplex Moulds on  
Super Casters numbered 70492  
to 71506 inclusive

*a1SU5\** **Adaptor Base Attachment**; consists of  
a28SE4E, 39SE1, 4SL6, 4SL13,  
4SL14(2), a31SL, 31SL2(2), 5SU

For use with Duplex Moulds on  
Super Casters numbered 71507  
and over

*e1SU5* **Adaptor Base Attachment**; consists of  
a28SE4E, 39SE1, X31SL, 5SU

For use with Triplex Moulds on  
Super Casters numbered 70492 to  
71506 inclusive

*a1SU7\** **Adaptor Base Attachment**; consists of  
a28SE4E, 39SE1, 4SL6, 4SL13,  
4SL14(2), X31SL, 59SL1,  
59SL3 assd., 59SL7 to 10 inclusive,  
59SL11(2), 59SL12(2), 59SL13,  
5SU

For use with Triplex Moulds on  
Super Casters numbered 71507  
and over

*b1SU7* **Adaptor Base Attachment**; consists of  
a28SE4E, 39SE1, X31SL, 59SL1,  
59SL3 assd., 59SL7 to 10 inclusive,  
59SL11(2), 59SL12(2), 59SL13,  
5SU

\*The .2" Extended Matrix Holder  
Xa4SL is necessary for use with  
Attachments a1SU5 and a1SU7



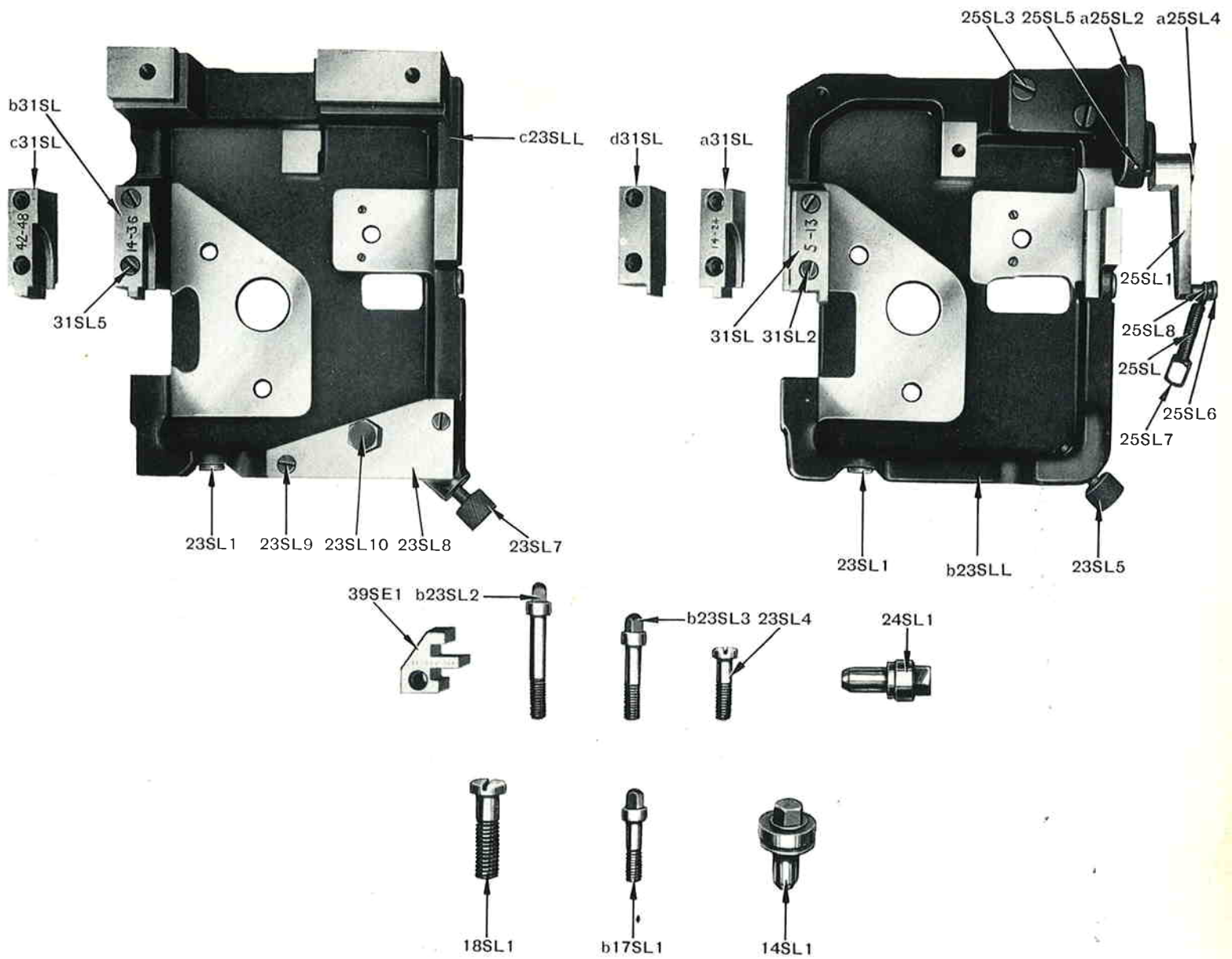

## 12SL

- 12SL **Mould Blade Fork**, 5-36 point and didot  
*12SL assd.\** Mould Blade Fork, assembled, 5-36 point and didot
- 12SL1 Bar  
12SL2 Guide Pin  
12SL3 Nut, knurled  
12SL4 Nut Lock Nut, knurled  
12SL5 Pin  
12SL6† Pin Handle  
12SL7 Pin Retaining Spring  
12SL8 Pin Retaining Spring Screw (2),  $\frac{1}{8}'' \times \frac{3}{16}''$

- X12SL* Mould Blade Fork, 5-36 point and didot, group; consists of 12SL assd., 12SL6  
\*12SL assd. consists of 12SL, 12SL1 to 5 inclusive, 12SL7, 12SL8(2)  
†Used also for 42-72 point and didot Moulds so that only ONE handle is required if both Mould Blade Forks are supplied

## 13SL

- 13SL **Mould Blade Fork**, 42-72 point and didot  
*13SL assd.\** Mould Blade Fork, assembled, 42-72 point and didot
- 13SL1 Bar  
13SL2 Guide Pin  
13SL3 Nut, knurled  
13SL4 Nut Lock Nut, knurled  
13SL5 Pin  
13SL6† Pin Handle  
13SL7 Pin Retaining Spring  
13SL8 Pin Retaining Spring Screw (2),  $\frac{1}{8}'' \times \frac{3}{16}''$

- X13SL* Mould Blade Fork, 42-72 point and didot, group; consists of 13SL assd., 13SL6  
\*13SL assd. consists of 13SL, 13SL1 to 5 inclusive, 13SL7, 13SL8(2)  
†Used also for 5-36 point and didot Moulds so that only ONE handle is required if both Mould Blade Forks are supplied

## 19SL

- 19SLL\***Mould Water Supply Piping**, Type Moulds 14-36 point and didot, Series 72,000  
*19SL1* Mould Water Supply Pipe, upper (not supplied separately, order 19SLL)  
*19SL2* Mould Water Supply Piping Block, to Mould (not supplied separately, order 19SLL)  
*19SL3* Mould Water Supply Piping Block, to Main Stand (not supplied separately, order 19SLL)

- 19SL4 Mould Water Supply Piping Block Screw,  $\frac{7}{32}'' \times \frac{11}{16}''$ , to Mould  
*X19SL* Mould Water Supply Piping, Type Mould 14-36 point and didot, Series 72,000, group; consists of 19SLL, 19SL4  
\*19SLL consists of 19SL, 19SL1, 2 and 3

## 20SL

- 20SLL\***Mould Water Supply Piping**, Type Mould, 42-72 point and didot, Series 74,000  
*20SL1* Mould Water Supply Pipe, upper (not supplied separately, order 20SLL)  
*20SL2* Mould Water Supply Piping Block, to Mould (not supplied separately, order 20SLL)  
*20SL3* Mould Water Supply Piping Block, to Main Stand (not supplied separately, order 20SLL)  
*20SL4* Mould Water Supply Piping Block Screw,  $\frac{7}{32}'' \times \frac{11}{16}''$ , to Mould  
*X20SL* Mould Water Supply Piping, Type Moulds, 42-72 point and didot, Series 74,000, group; consists of 20SLL, 20SL4  
\*20SLL consists of 20SL, 20SL1, 2 and 3

## 21SL

- 21SLL\***Mould Water Supply Piping**, Lead and Rule and Furniture Moulds  
*21SL1* Mould Water Supply Pipe, upper (not supplied separately, order 21SLL)  
*21SL2* Mould Water Supply Piping Block, to Mould (not supplied separately, order 21SLL)  
*21SL3* Mould Water Supply Piping Block, to Main Stand (not supplied separately, order 21SLL)  
*21SL4* Mould Water Supply Piping Block Screw,  $\frac{1}{4}'' \times \frac{7}{8}''$   
*X21SL* Mould Water, Supply Piping Lead and Rule and Furniture Moulds, group; consists of 21SLL, 21SL4  
\*21SLL consists of 21SL, 21SL1, 2 and 3

## 22SL

- 22SL1* **Mould Water Supply Piping Box**

## 30SL

- 30SLL\***Mould Water Supply Piping**  
*30SL1* Mould Water Supply Pipe, upper (not supplied separately, order 30SLL)

- 30SL2* Mould Water Supply Piping Block, to Mould (not supplied separately, order 30SLL)  
*30SL3* Mould Water Supply Piping Block, to Main Stand (not supplied separately, order 30SLL)  
*30SL4* Mould Water Supply Piping Block Screw,  $\frac{7}{32}'' \times \frac{11}{16}''$   
*X30SL†* Mould Water Supply Piping group; consists of 30SLL, 30SL4  
\*30SLL consists of 30SL, 30SL1, 2 and 3  
†Used for Adaptor Base for Display Mould and Composition Mould so that only ONE group is required if both Adaptor Bases are supplied

## 32SL

### ADAPTOR BASE ATTACHMENT 2SU1

- 32SL **Mould Blade Fork**, Display Mould, 42-48 point and didot
- 32SL1 Bar  
32SL2 Guide Pin  
32SL3 Nut, knurled  
32SL4 Nut Lock Nut, knurled  
32SL5 Pin  
Pin Handle, use the Handle 12SL6 supplied as part of the Super Caster equipment  
32SL6 Pin Retaining Spring  
32SL7 Pin Retaining Spring Screw (2),  $\frac{1}{8}'' \times \frac{3}{16}''$
- X32SL* Mould Blade Fork, Display Mould, 42-48 point and didot, group; consists of 32SL, 32SL1 to 6 inclusive, 32SL7(2)

## 2SU

### Adaptor Base Attachment

- Object: To enable Series "S" Display Moulds to be used on the Super Caster  
For Series "S" Display Moulds 14-36 point and didot on Super Caster
- 2SU* **Adaptor Base Attachment**; consists of 39SE1, Xc23SL, 24SL1(2), X30SL
- For Series "S" Display Moulds 42-48 point or didot on Super Caster
- 2SUI* **Adaptor Base Attachment**; consists of 12SH5, c31SL, X32SL. When applying this Attachment, the Adaptor Base Attachment 2SU must also be ordered, unless already fitted to the machine

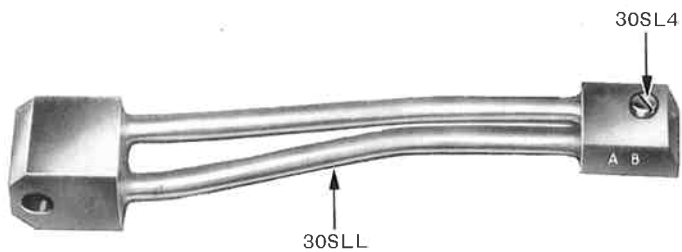

30SLL

30SL4

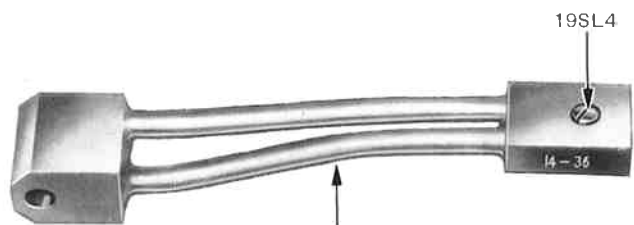

19SLL

19SL4

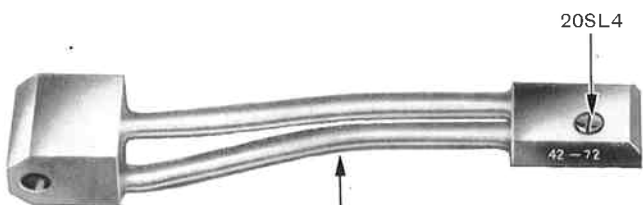

20SLL

20SL4

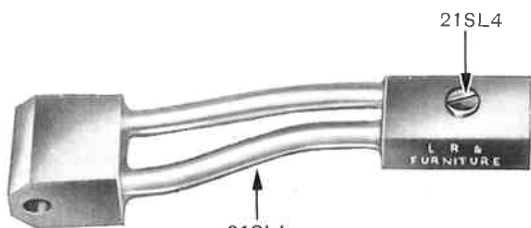

21SLL

21SL4

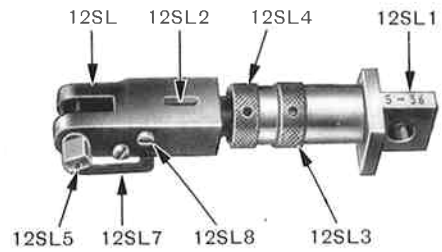

12SL5 12SL7 12SL8 12SL3

12SL

12SL2

12SL4

12SL1



12SL6

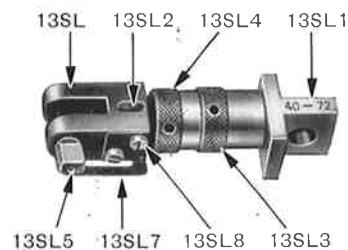

13SL5 13SL7 13SL8 13SL3

13SL

13SL2

13SL4

13SL1

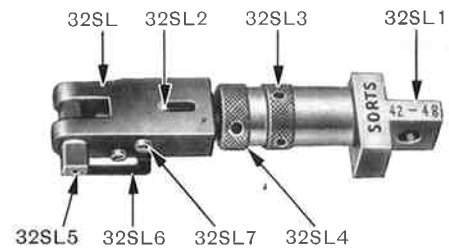

32SL5 32SL6 32SL7 32SL4

32SL

32SL2

32SL3

32SL1